



CERTIFICATE OF SURVEYOR

State of Wyoming)
County of Teton) ss

I, N.G. Harms, of Jackson, Wyoming hereby certify that this map was made from notes taken during an actual survey made under my direction by C.L. Dowdell, Wyoming L. S. Registration No. 522, during the months of June and July 1972, and that it correctly represents the Teton Wilderness Ranch--First Filing being a part of the SW 1/4 of Section 20, T45N, R113W, 6th P.M., Teton County, Wyoming more particularly described as follows:

Commencing at the SW 1/4 Corner of said Section 20, which is a standard brass cap marked 1/4 Corner Section 20/Section 29 and is the point of beginning; thence N07°28'50"W a distance of 2293.956 feet along the South line of said Section 20 to a point which is on the centerline of Lava Creek; thence continuing along said centerline of Lava Creek N50°01'34"W a distance of 64.13 feet; thence N12°16'47"W a distance of 224.62 feet; thence N73°26'18"E a distance of 115.61 feet; thence N47°23'50"E a distance of 91.14 feet; thence N18°21'47"E a distance of 194.66 feet; thence N16°02'52"W a distance of 135.50 feet; thence N32°55'36"E a distance of 87.11 feet; thence N21°53'43"E a distance of 129.28 feet; thence N30°00'26"W a distance of 63.64 feet at which point the survey leaves the centerline of said Lava Creek; thence S87°28'50"E a distance of 407.20 feet; thence Northerly along the arc of a curve, Radius 137.690 feet, Delta 34°37'17" a distance of 83.20 feet; thence S55°06'00"E a distance of 60.00 feet; thence Southerly along the arc of a curve, Radius 77.690 feet, Delta 42°09'01" a distance of 57.153 feet; thence S7°15'00"E a distance of 172.93 feet; thence East a distance 594.04 feet; thence S85°16'00"E a distance of 241.00 feet; thence S75°52'00"E a distance of 222.00 feet; thence N88°50'00"E a distance of 205.00 feet; thence N29°57'26"W a distance of 174.65 feet; thence N58°54'00"E a distance of 305.81 feet; thence S31°06'00"E a distance of 350.88 feet; thence Southerly along the arc of a curve, Radius 146.872 feet, Delta 30°53'48" a distance of 79.20 feet to a point on the North-South centerline of said Section 20; thence S0°12'12"E along said North-South centerline of Section 20 a distance of 682.96 feet to the point of beginning.

The above described parcel of land contains 42.607 acres more or less.

N.G. Harms
N. G. Harms P. E. & L. S. WYO. REG. NO. 656

The foregoing instrument was acknowledged before me this 31st day of July, 1972.
Witness my hand and official seal

James M. Harms
Notary Public My Commission Expires January 4, 1975

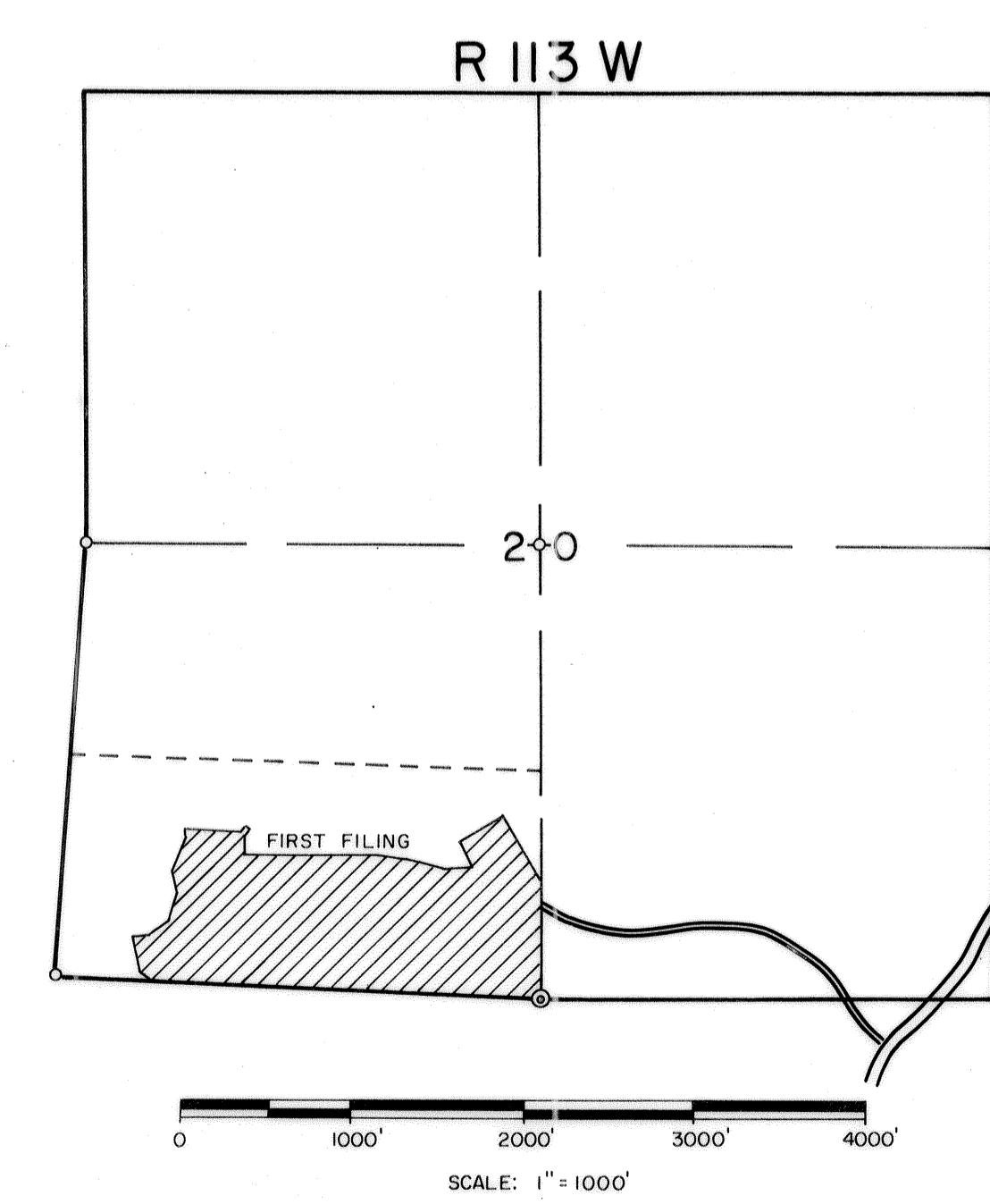
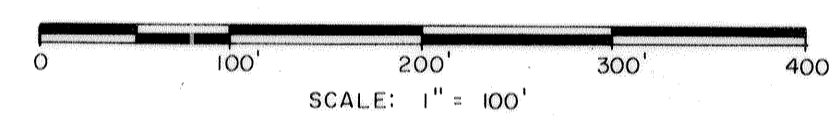

NOTE:
* Roads to be continued on Second Filing

LEGEND
o 5/8" Rebar
⊙ Standard BLM Brass Cap

CURVE DATA

NO.	DELTA	CURVE	TANGENT	CHORD	RADIUS
1	82°34'00"	125.188	76.274	114.633	86.872
*2	36°19'00"	193.259	100.00	190.040	304.899
*3	16°41'00"	99.292	50.00	98.942	341.001
*4	39°07'00"	192.172	100.00	188.461	281.482
*5	42°30'00"	171.671	90.00	167.762	231.436
*6	42°09'00"	79.223	41.50	77.448	107.690
*7	46°58'41"	188.668	100.00	183.428	230.105
*8	13°20'00"	99.548	50.00	99.324	427.777
9	66°56'00"	52.907	29.939	49.950	45.290
10	61°23'48"	82.877	45.919	78.769	77.342

Note: all other curves have a 25' radius
* These curves are on centerline of road

Global Engineering And Land Surveying

CERTIFICATE OF APPROVAL

Pursuant to Section 34-114, Wyoming Statutes, 1957, as amended, the foregoing described TETON WILDERNESS RANCH ADDITION was approved at the regular meeting of the Board of County Commissioners held on the 5th day of Sept. 1972. Subject to the provisions of a resolution for the approval of subdivision and townsite plats as adopted on 1 August 1967.

ATTEST: BOARD OF COUNTY COMMISSIONERS
COUNTY OF TETON

V. Jolynn Coonce
Mrs. V. Jolynn Coonce, Clerk

Arthur E. Brown, Jr.
Arthur E. Brown, Jr., Chairman

CERTIFICATE OF OWNERS

State of Wyoming)
County of Teton) ss

Know all men by these presents that Richard E. Shanor and Karl M. Johnson do hereby certify that the foregoing subdivision of a part of the SW 1/4 Section 20, T45N, R113W, 6th P.M., Teton County, Wyoming as shown on this map and more particularly described under the Certificate of Surveyor is with the free consent and in accordance with the desires of the undersigned owners and proprietors of the said lands, the name of the subdivision shall be TETON WILDERNESS RANCH - FIRST FILING and that the subdivision is subject to convenants and restrictions of record. All streets as shown on plats are dedicated to public use.

Richard E. Shanor
Richard E. Shanor

Karl M. Johnson
Karl M. Johnson - Single Man

Jean Shanor
Jean Shanor - Wife

James M. Harms
Notary Public

My Commission Expires 8-16-73

Recorded 9-19-1972 at 2:00 o'clock P.M.
in Book 1 of Maps Page 7
No. 125436
V. Jolynn Coonce
County Clerk

MAP OF
TETON WILDERNESS RANCH
FIRST FILING
BEING PART OF SW 1/4
SECTION 20 T45N - R113W
TETON COUNTY, WYOMING

Jackson, Wyoming